

V912 Y pattern strainer (2 x flange)

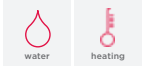

specification

- all sizes rated PN16
- 1.5 to 3mm aperture mesh
- raised flanged to EN 1092-2
- ductile iron body

DN	Connection	Code	Weight (kg)	Cv	Kv
DN65	2 1/2"	15361	14.50	108.81	93.0
DN80	3"	15362	17.50	159.12	136.0
DN100	4"	15363	31.25	267.93	229.0
DN125	5"	15364	43.00	424.71	363.0
DN150	6"	15365	62.50	583.83	499.0
DN200	8"	15366	107.00	955.89	817.0
DN250	10"	15367	196.67	1592.37	1361.0
DN300	12"	15368	253.00	2255.76	1928.0

*Cv - flow rate in US GPM at a pressure drop of 1 psi.
 *Kv - flow rate in m3 per hour at a pressure drop of 1 bar.

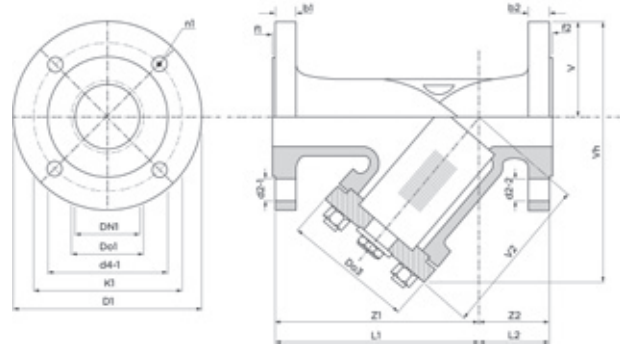

Dimensions (mm)

	b1/b2	d2-1/d2-2	Do2	Do3	f1/f2	L1	L2	V	V2	Vh	Z1	Z2
DN65	20.0	19.0	76.0	80.0	3.0	72.0	201.0	93.0	195.0	270.0	72.0	201.0
DN80	20.0	19.0	88.0	92.0	3.0	83.0	212.0	100.0	220.0	302.0	83.0	212.0
DN100	22.0	20.0	114.0	108.0	3.0	99.0	252.0	110.0	257.0	346.0	99.0	252.0
DN125	22.0	20.0	139.0	128.0	3.0	118.0	298.0	125.0	318.0	414.0	118.0	298.0
DN150	24.0	20.0	168.0	148.0	3.0	138.0	331.0	143.0	332.0	451.0	138.0	331.0
DN200	26.0	21.0	219.0	187.0	3.0	177.0	366.0	170.0	440.0	575.0	177.0	366.0
DN250	29.0	21.0	273.0	227.0	3.0	216.0	448.0	203.0	513.0	679.0	216.0	448.0
DN300	32.0	25.0	323.0	267.0	3.0	256.0	514.0	230.0	863.0	974.0	256.0	514.0

	D1	DN1	Do1	d4-1	k1	n1
DN65	185.0	DN65	76.0	118.0	95.0	4.0
DN80	200.0	DN80	88.0	132.0	106.0	4.0
DN100	220.0	DN100	114.0	156.0	122.0	4.0
DN125	250.0	DN125	139.0	184.0	138.0	4.0
DN150	285.0	DN150	168.0	211.0	188.0	4.0
DN200	340.0	DN200	219.0	268.0	206.0	4.0
DN250	405.0	DN250	273.0	319.0	281.0	4.0
DN300	460.0	DN300	323.0	370.0	330.0	4.0

Material specification

Nr	Component	Material
1	Body	Ductile iron
2	Cap	Ductile iron
3	Cover	Ductile iron
4	Strainer	Stainless steel
5	Seal	Fibre TesnitBA-U
6	Screen	Stainless steel
7	Gasket	Graphite
8	Plug	Brass

Maximum pressure conditions

Size	Max Pressure (bar)	Min/Max Temperature (°C)	Test Pressure Shell (bar)	Test Pressure Seat (bar)	Max Pressure (psi)	Min/Max Temperature (°F)	Test Pressure Shell (psi)	Test Pressure Seat (psi)
DN65 to DN300	16.0	-10°C + 120°C	24.0	17.5	232.1	14°F + 248°F	348.1	253.8

Pressure equipment directive category

All sizes classified SEP

Stainless steel mesh

DN65 - DN80	1.5mm hole
DN100 - DN300	3mm hole

Pressure & temperature ratings

